



# DOBSON ARENA

VAIL, COLORADO

2026





# TABLE OF CONTENTS

THE VENUE AT A GLANCE	3
SPACES & CAPABILITIES	7
THE VAIL EXPERIENCE & DESTINATION	16



ABOUT DOBSON ARENA

# THE VENUE AT A GLANCE





# WHY CHOOSE DOBSON ARENA?

Nestled in the heart of Vail, Dobson Arena has been reimagined as a modern, multi-use event venue while honoring its roots as a Colorado icon. With over 56,000 square feet of total space, the arena's thoughtful renovation blends state-of-the-art production capabilities with alpine character creating a space unlike any other in the Rockies.

Dobson Arena transforms from ice arena to event center, offering a range of opportunities for concerts, conferences, exhibitions, and corporate gatherings. The 2025 upgraded infrastructure features expanded entries, all new and expanded restrooms, ADA accessibility, and enhanced acoustics.

West Rendering



Town of Vail | DOBSON ARENA | Vail Recreation District Rec Subcommittee Meeting 11/19/2024







<b>3,500+</b>	Total Capacity for Concerts and Keynote Events	<b>56,487 ft<sup>2</sup></b>	Total Square Footage Post-Remodel	<b>1,021</b>	Paid Public Parking Spots	<b>81</b>	Internal Bathroom Fixtures with additional units available.
---------------	------------------------------------------------	------------------------------	-----------------------------------	--------------	---------------------------	-----------	-------------------------------------------------------------

# VENUE OVERVIEW

- Location in the heart of Vail, Colorado, just minutes from hotels, dining, and mountain activities
- ADA-compliant upgrades to entries, restrooms, and elevator access
- Expanded west and south entries for improved guest flow
- Improved rigging capacity



**MODERN ACCESSIBILITY**  
ADA-compliant pathways and entries.



**CONCESSIONS & FOOD SERVICE**  
Available during events, with options for custom catering.



**BATHROOMS**  
Expanded capacity, ADA-compliant restrooms.



**HOSPITALITY SPACES**  
VIP lounge, green rooms, meeting rooms.



**ENTRANCES & CIRCULATION**  
New west and south entries for smooth ingress/egress.



**NOISE MITIGATION**  
Enhanced sound barriers and site design to comply with 65 dBA property line limits.



# VENUE EXPERIENCE & VERSATILITY

Dobson Arena has been intentionally updated to host an array of events. The space can host anything from creative summits, trade shows, live performances, immersive brand experiences, product launches, fundraising galas, and more. Improved audio and video capabilities, a range of stage configurations, and green room capabilities create a space that can be tailored to any event, all surrounded with a stunning mountain backdrop.

## CORPORATE RETREATS AND SUMMITS



## NATIONAL ASSOCIATION CONVENTIONS



## CONCERTS, SPEAKER SERIES, AND LIVE PERFORMANCES



## BRAND ACTIVATIONS, PRODUCT LAUNCHES, AND EXHIBITIONS





# WHAT YOU NEED TO KNOW

# SPACES & CAPABILITIES





# EVENT LEVEL

2,400 FLOOR STANDING CAPACITY

## Features

**Large stage area with backstage and loading dock access**

**Locker rooms, skate rental, and back-of-house support space**

**ADA wheelchair platform and penalty box viewing for sporting events**

The event and concert level has a 2,400 standing capacity on the floor with a large stage area, backstage area, and loading docks. For sports events, we have locker rooms, skate rentals and back of house support spaces. ADA wheelchair platforms.





# CONCOURSE LEVEL

1,050 FIXED SEATING CAPACITY

## Features

- Concessions, lounge and hospitality spaces
- Large lobby and circulation areas for registration and networking

The Concourse Level features fixed seating that can accommodate up to 1,400 people at standing room only. With ample space and ADA-friendly walkways, getting around the concourse is a breeze. The Concourse Level also includes a lounge space. Concession stands and staffing can be around the concourse as well.





# CONCOURSE LAYOUT

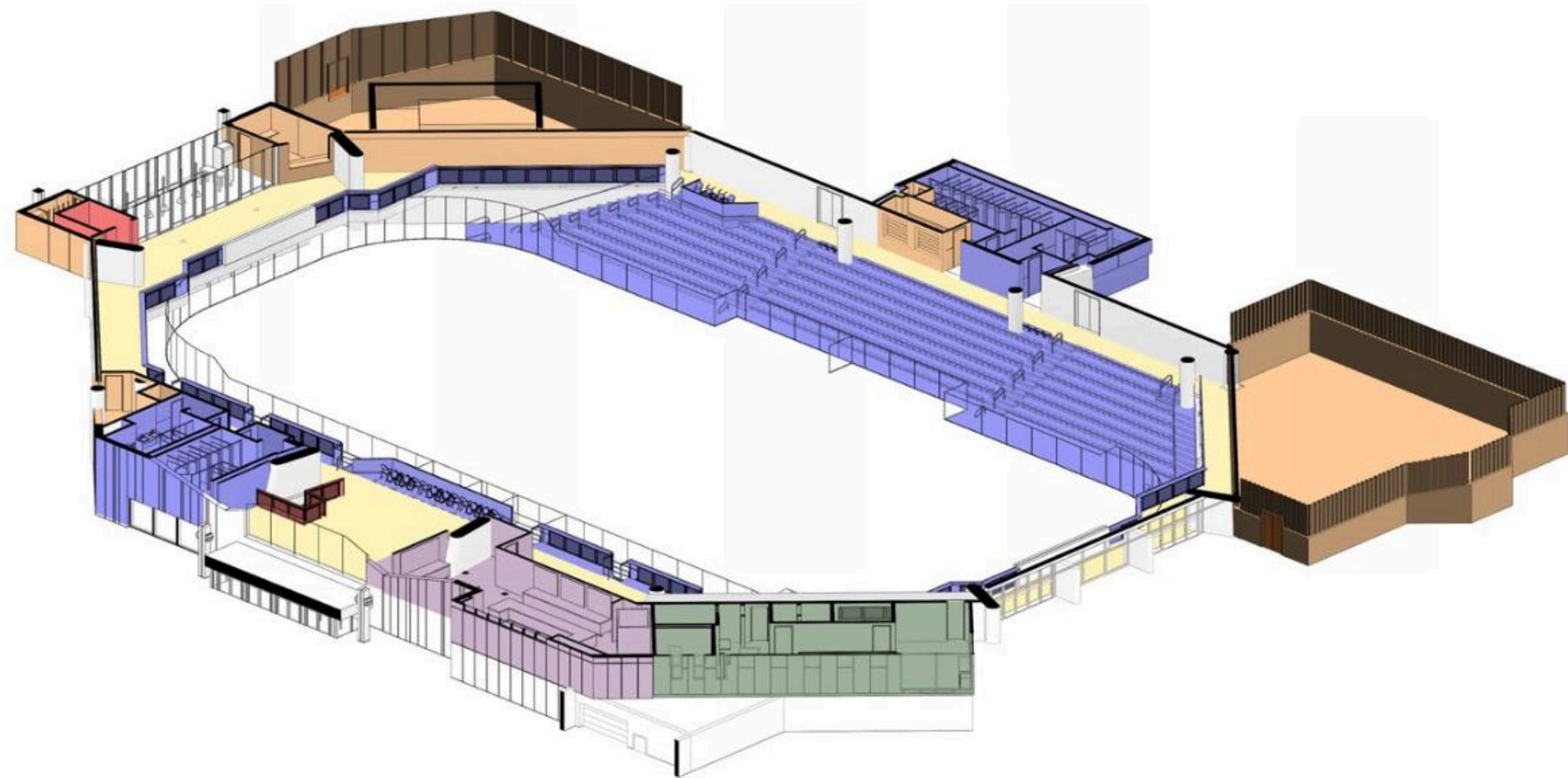

- Circulation
- Retail/Food Service
- Administration

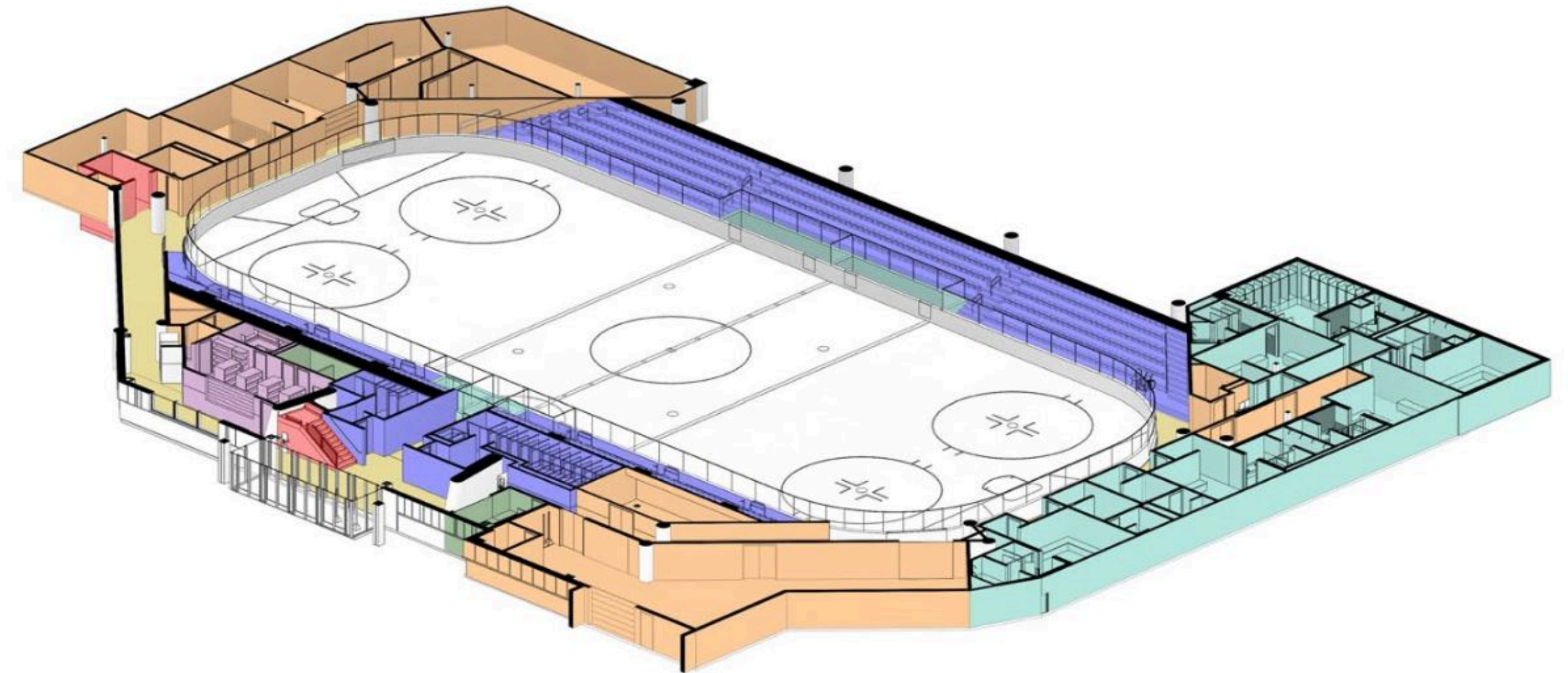

- Spectator Facilities
- MEP & Support
- Vertical Circulation



# CONCERT FLOOR PLAN

TOTAL CAPACITY	3,500
SEATED CAPACITY	1,050
STANDING CAPACITY	3,500

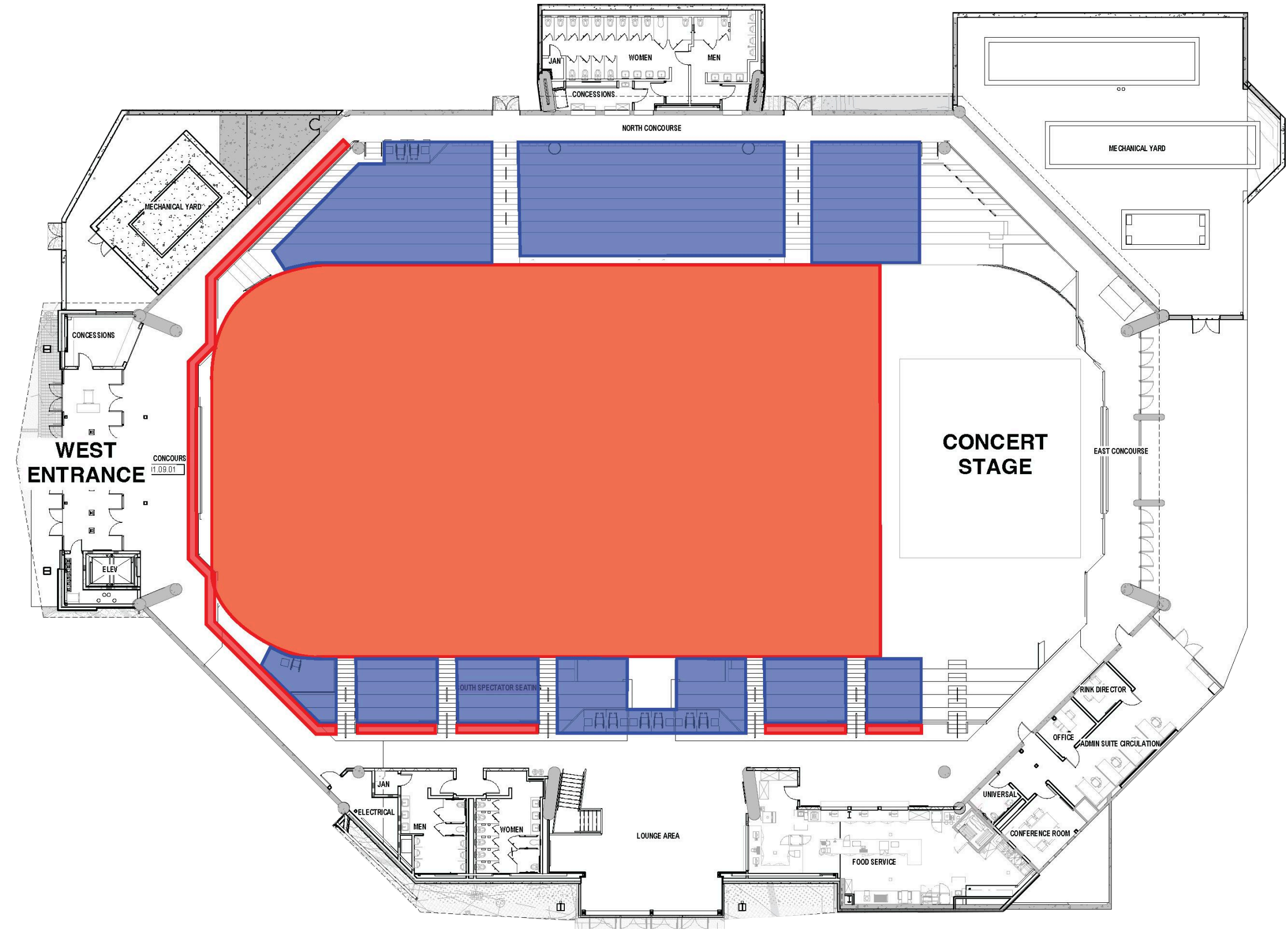
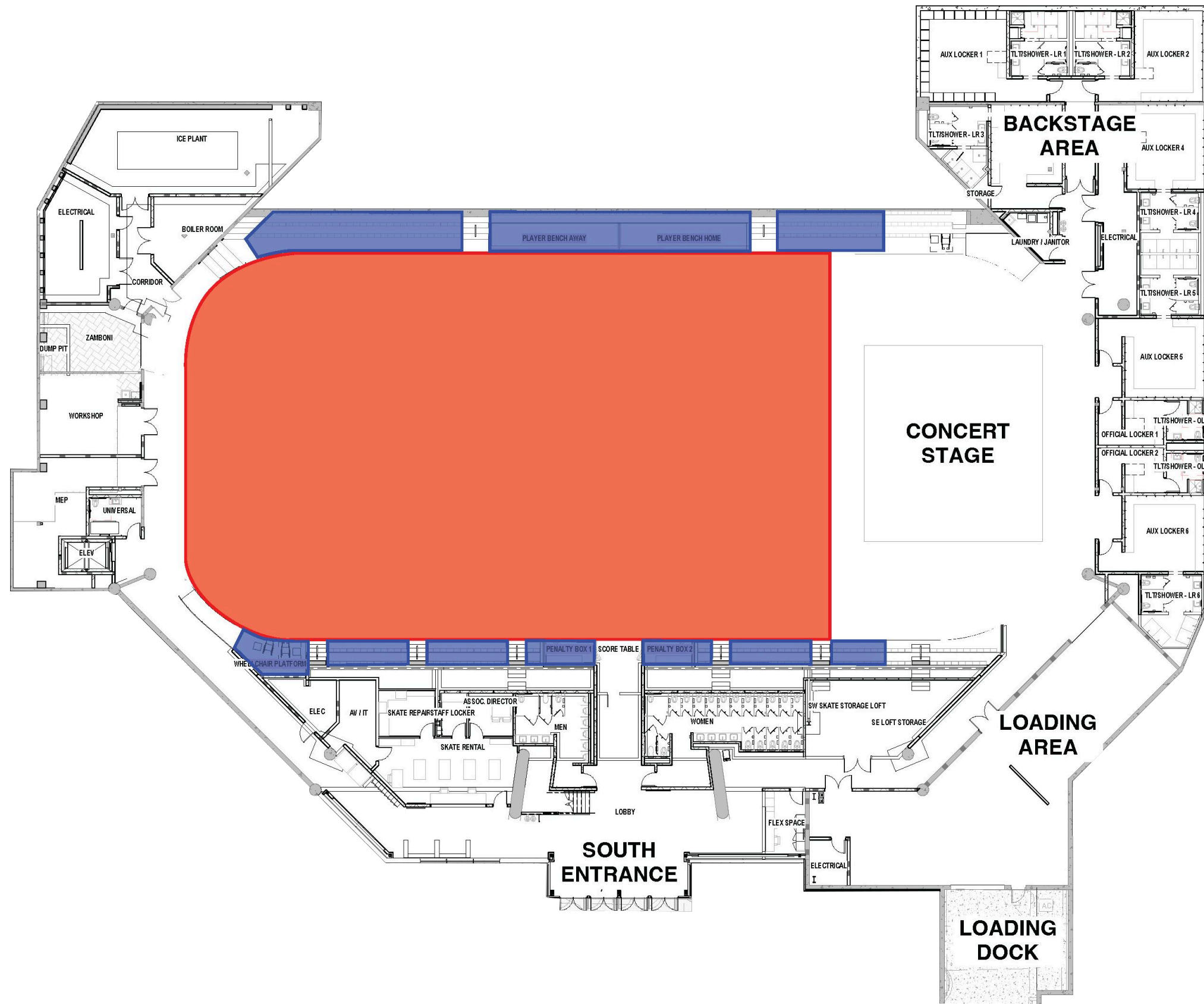

## CONCOURSE LEVEL

<b>Seated Capacity</b>	<b>1,050</b>
------------------------	--------------



A CHOICE MOUNTAIN DESTINATION

# THE VAIL EXPERIENCE





# WELCOME TO VAIL

## A WORLD-CLASS RESORT TOWN

Vail is a serene European-style village where pedestrian-friendly streets wind between old-world Bavarian architecture and open to views of unencumbered wilderness. Stroll and explore shops and restaurants along Gore Creek and discover a special place where the fresh air makes life feel a bit lighter.





# WHY VAIL?

## SUPERIOR DINING AND LODGING

From charming diners to upscale fine dining, including several MICHELIN-recommended establishments, Vail's restaurants cater to diverse tastes. Vail boasts numerous highly-rated lodging options whether you're looking for a boutique experience or a big name hotel brand.



## YEAR-ROUND ATTRACTIONS

Whether the mountains are covered in powdery snow or lush green grass there's always something to do around Vail. From snow sports to fishing and rafting the area is full of outdoor activities. More of a city person? Vail's villages are full of shops, bars, and restaurants to keep you busy.



## EASY OF ACCESS FOR AIR TRAVEL

Getting to Vail is quick and easy. Just 30 miles from Vail, Eagle County Regional Airport (EGE) is serviced by American, Delta, Alaska and United from over 150 cities worldwide. With full-service transportation available from the airport, traveling directly into Vail is more convenient than ever!



## VILLAGE ATMOSPHERE

Vail is connected with pedestrian streets (and a free in-town shuttle system) following the winding Gore Creek from Vail Village to Lionshead. Stroll and explore shops and restaurants after your mountain adventure, bar hop at night, and more. Beyond the core villages, you'll discover East and West Vail, both offering lodging, dining and shopping just a short drive or free bus ride away.







**Breweries & Distilleries**



**5-Star Dining**



**Skiing & Snowboarding**



**Bars & Nightlife**



**Hiking & Biking**



**Golfing**

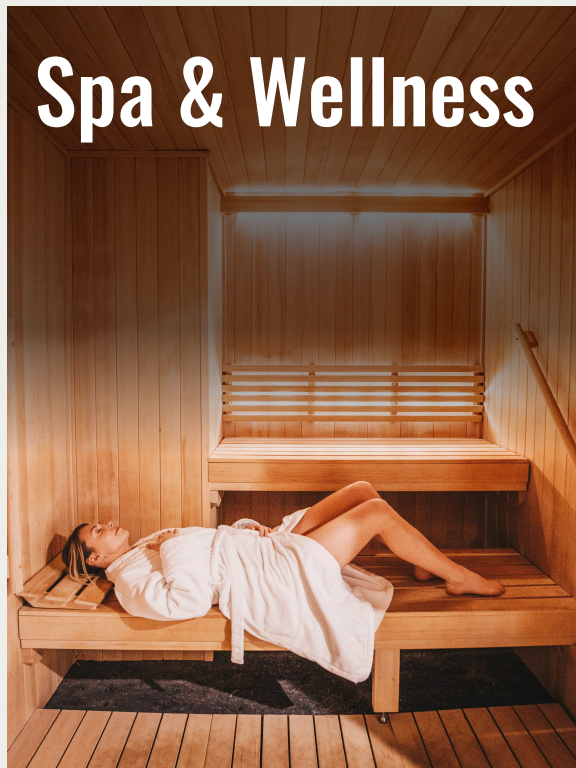

**Spa & Wellness**



**Shopping in the Villages**



**Scenic Gondola**



**Art, Theatre & Culture**

# THINGS TO DO

LEARN MORE AT [DISCOVERVAIL.COM](https://www.discovervail.com)



# BRING YOUR NEXT EVENT TO THE HEART OF THE ROCKIES

## CONTACT US

SCHEDULE A SITE TOUR OR  
REQUEST A CUSTOM PROPOSAL.

### VENUE COORDINATOR

Vail Recreation District  
970-479-2271 | [Dobson@vailrec.com](mailto:Dobson@vailrec.com)